

链号 Chain No.	节距 Pitch	套筒外径 Bush outer diameter	链节小端内宽 Inner width on narrow end	链节大端内宽 Inner width on wide end	销轴直径 Pin diameter	销轴长度 Pin length		链板高度 Plate depth	链板厚度 Plate thickness	极限拉伸载荷 Ultimate tensile strength		每米重量 Mass per meter
						销轴热处理 Pin heat-treatment	全部热处理 All parts heat-treatment					
GB ISO	p	d1 max	b1 min	b3 min	d2 max	L max	Lc max	h2	T	only min	eatment min	q ≈
	mm	mm	mm	mm	mm	mm	mm	mm	mm	kN	kN	kg/m
W78	66.27	22.90	28.40	51.60	12.78	82.3	84.8	28.40	6.40	93.4	106.8	6.20
W82	78.10	31.50	31.80	57.90	14.35	86.9	90.0	31.80	6.40	100.1	131.2	8.00
W106	152.40	37.10	41.20	72.10	19.13	115.8	118.6	38.10	9.70	169.0	224.6	10.60
W110	152.40	32.00	46.70	77.00	19.13	114.3	117.1	38.10	9.70	169.0	224.6	10.40
W111	120.90	37.10	57.20	86.40	19.13	127.8	133.3	38.10	9.70	169.0	224.6	12.72
W124	101.60	37.10	41.20	72.10	19.13	115.8	118.4	38.10	9.70	169.0	224.6	12.38
W124H	103.20	41.70	41.20	77.00	22.30	128.3	133.1	50.80	12.70	275.8	355.9	19.70
W132	153.67	44.70	76.20	112.30	25.48	162.5	167.3	50.80	12.70	275.8	378.1	20.00
W855	153.67	44.70	69.85	118.87	28.78	173.7	179.3	63.50	15.87	—	552.0	24.60

A2附件

A2 attachments

K2附件

K2 attachments

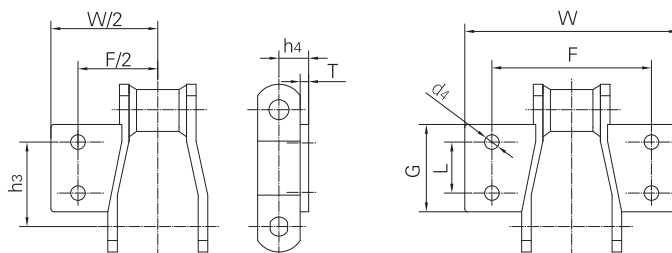

链号 Chain No.	h3	G max	F	W max	h4 max	d4	T
	mm	mm	mm	mm	mm	mm	mm
W78	31.80	36.60	101.60	130.00	22.40	9.70	6.40
W82	38.10	46.00	106.70	142.70	23.90	9.70	6.40